

Deuxe

Massage Chair

R8775W

Please read the user manual carefully before use.

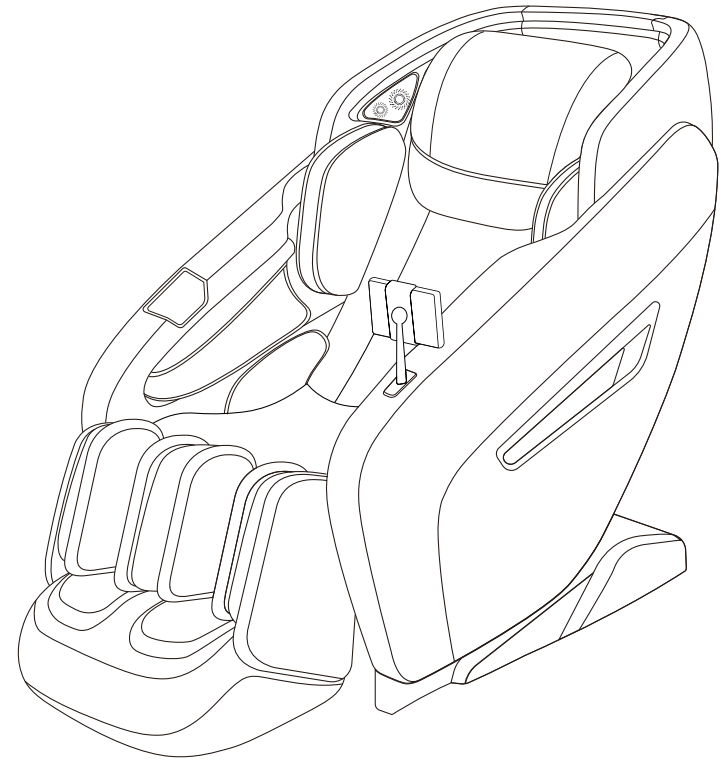

Thank you for choosing our product and your support. In order to understand the directions fully, please read user's manual carefully. And after reading, please keep it for next browsing. We reserve the right of final explanation to the design of product. Dimensions and specifications are subject to change without notice for further improvement.

Contents

Safety	1-6
Components	7
Functions	8
Touch Screen Instructions	9-11
Preparation Before Use	12-16
Cleaning and Maintenance	17
Troubleshoot	18
Specifications	19

Safety

IMPORTANT SAFETY INSTRUCTIONS

This massage chair is intended for household only .When using an electrical appliance, basic precautions should always be followed, including the following:

Read all instructions before using this massage chair.

DANGER-To reduce the risk of electric shock:

- 1) Always unplug this appliance from the electrical outlet immediately after using and before cleaning.
- 2) Never use pins or other metallic fasteners with this appliance.
- 3) Carefully examine the covering before each use. Discard the appliance if the covering shows any sign of deterioration, such as checking, blistering, or cracking.
- 4) Keep Dry - Do not operate in a wet or moist condition.

WARNING-To reduce the risk of burns, fire, electric shock, or injury to persons:

- 1) An appliance should never be left unattended when plugged in. Unplug from outlet when not in use, and before putting on or taking off parts.
- 2) Do not operate under blanket or pillow. Excessive heating can occur and cause fire, electric shock, or injury to persons.
- 3) Close supervision is necessary when this appliance is used by, on, or near children, invalids, or disabled persons. Keep children away from extended foot support.
- 4) Use this appliance only for its intended use as described in this manual. Do not use attachments not recommended by the manufacturer.
- 5) Never operate this appliance if it has a damaged cord or plug, if it is not working properly, if it has been dropped or damaged, or dropped into water.
Return the appliance to a service center for examination and repair.
- 6) Do not carry this appliance by supply cord or use cord as a handle.
- 7) Keep the cord away from heated surfaces.
- 8) Never operate the appliance with the air openings blocked. Keep the air openings free of lint, hair, and the like.
- 9) Never drop or insert any object into any opening.

Safety

- 10) Do not use outdoors.
- 11) Do not operate where aerosol (spray) products are being used or where oxygen is being administered.
- 12) To disconnect, turn all controls to the off position, then remove plug from outlet.
- 13) Temperatures sufficiently high to cause burns may occur regardless of the control setting. Do not use on an infant or invalid or on a sleeping or unconscious person. Do not use on insensitive skin or on a person with poor blood circulation. Check the skin in contact with the heated area of the appliance frequently to reduce the risk of blistering.
- 14) Do Not Crush - Avoid sharp folds.
- 15) Do not use massager in close proximity to loose clothing or jewelry.
- 16) Keep long hair away from massager while in use.
- 17) Connect this appliance to a properly grounded outlet only. See Grounding Instructions.
- 18) The apparatus shall not be exposed to dripping or splashing and that no objects filled with liquids, such as vases, shall be placed on the apparatus.
- 19) An apparatus with CLASS I construction shall be connected to a MAINS socket outlet with a protective earthing connection
- 20) The appliance coupler is used as the disconnect device, the disconnect device shall remain readily operatable.
- 21) This appliance is not intended for use by persons (including children) with reduced physical, sensory or mental capabilities, or lack of experience and knowledge, unless they have been given supervision or instruction concerning use of the appliance by a person responsible for their safety.
- 22) If it is not in use for a long time or after use, please turn off the power and pull out the power plug.
- 23) Do not damage, break, over-bend, compress, tighten, wind, rotate or knot the power cord.

Safety

SAVE THESE INSTRUCTIONS

This massage chair is intended for household use only.

● Usage Environment

- Do not use the massage chair in an excessively humid or dusty environment as this may result in malfunction or electric shock.
- Do not use the massage chair in a room with a temperature of 104°F or higher.
- Do not expose the massage chair to heaters, stoves or direct sunlight.
- Place and use the massage chair on an even, non-slip floor.
- The massage chair is designed for home use and not for commercial purposes.

Caution

- The massage chair is to be used indoors only.
- If you use the massage chair in a cold room, do not increase the room temperature abruptly. It is recommended that you increase the temperature gradually to a normal level.
- If the massage chair is stored in a cold place and is being brought into a warm environment, it is advisable to wait one hour before use. This is because its performance may not be at optimum level, as there may be water droplets on the mechanical parts due to condensation. Using the massage chair under such conditions may result in malfunction.

IMPORTANT SAFETY INSTRUCTIONS

● Safety Precautions

- To ensure safe and correct use of the massage chair, do not operate it without reading this operation manual carefully.
- Do not use the massage chair when the upholstery or seat is removed. This may cause injury or malfunction.
- Do not use the massage chair in combination with other therapeutic equipment or electric blanket, etc., as this may result in ineffectiveness or injury.
- Do not use the massage chair an hour before or after eating as this may have adverse effects on the user.
- Do not allow children or pets to play around the massage chair, e.g., behind the backrest, under the seat or leg rest of the massage chair. This may result in injury.

Safety

- Do not rest or place heavy objects on the armrests, leg rest or backrest as this may result in malfunction or injury.
- Do not use the massage chair when your body is wet.
- Do not operate the massage chair with wet hands.
It is not recommended to use the massage for more than 15 minutes.
- Do not perform continuous massage on the same spot of your body for more than 5 minutes at a time as this may result in excessive stimulation and may have adverse effects.
- Do not insert your hand or foot along the paths of the massage rollers during use as this may cause injury.
- Stop operation immediately if you experience any discomfort.
- This product is not intended for self-treatment of conditions that should be managed by a qualified health care provider.
- People on medication or with medical conditions, please consult your doctor before use.
- Please do not use the product if you are not feeling well.
- Remove all scarves, neckties, necklaces and jewelry before using the massager.

● People with Medical Conditions

Consult your doctor before use if you:

- are under medical rest as ordered by a doctor.
- have spinal disorders, an abnormal spinal condition or have suffered a spinal injury.
- have back problems.
- have diabetes, osteoporosis or sensory impairment.
- have joint dysfunction.
- have a pacemaker or other electronic medical devices.
- may be pregnant.
- have phlebitis or thrombosis.
- have an increased risk for blood clots.
- had recent surgery.
- have surgical pins, screws, or anything mechanical implanted in your body.

Safety

● Instances When the massage chair Should Not Be Used

In the following events, please switch off the main power switch immediately and disconnect the power cord from the electrical outlet:

- If water is accidentally spilled onto the massage chair. This may result in electric shock or malfunction.
- If the fabric of the backrest is torn and the internal components are exposed.
- If pain or discomfort is felt during massage, stop operation immediately and consult your doctor.
- If you detect any malfunction or any other abnormal condition during operation.
- If there is a power failure. Injury may occur when power is restored unexpectedly.
- If there is lightning.

● Assembly and Repair of the massage chair

- Do not disassemble the backrest cover of the massage chair. Touching the internal components may result in malfunction or electric shock.
- The massage chair must only be professionally serviced or repaired. Do not attempt to disassemble or repair the massage chair yourself.

● Things to Note About the Power Plug and Cord

- Check that the Alternating Current (AC) voltage corresponds with the specifications indicated for the massage chair.
- Do not connect or disconnect the power plug from the electrical outlet with wet hands. This may result in malfunction or electric shock.
- When disconnecting the power plug, pull it by holding the plug, not the cord.
- Although operation will be stopped automatically by the Auto-Timer function, always remember to switch off the main power switch after use.
- Do not place the power cord under the massage chair or any other heavy objects.
- Do not wind the power cord around the massage chair as this may damage the cord and result in a fire or electric shock.
- Do not operate the massage chair with a damaged cord or extension cord.
- Do not use the massage chair if the electrical outlet is loose.
- If the power cord is damaged, it should be replaced by a qualified technician.

Safety

● Grounding Instructions

This product must be grounded. If it should malfunction or breakdown, grounding provides a path of least resistance for electric current to reduce the risk of electric shock. This product is equipped with a cord having an equipment-grounding conductor and a grounding plug. The plug must be plugged into an appropriate outlet that is properly installed and grounded in accordance with all local codes and ordinances.

DANGER - Improper connection of the equipment-grounding conductor can result in a risk of electric shock. Check with a qualified electrician or serviceman if you are in doubt as to whether the product is properly grounded. Do not modify the plug provided with the product - if it will not fit the outlet, have a proper outlet installed by a qualified electrician.

This product is for use on a nominal 100-240V~ circuit and has a grounding plug that looks like the plug illustrated in sketch A as following illustration. Make sure that the product is connected to an outlet having the same configuration as the plug. No adapter should be used with this product.

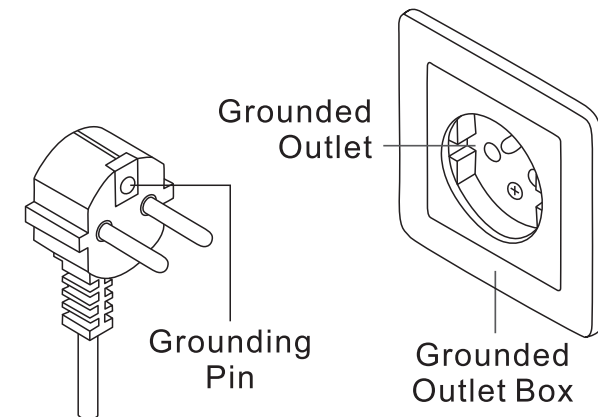

Components

Outer Structure

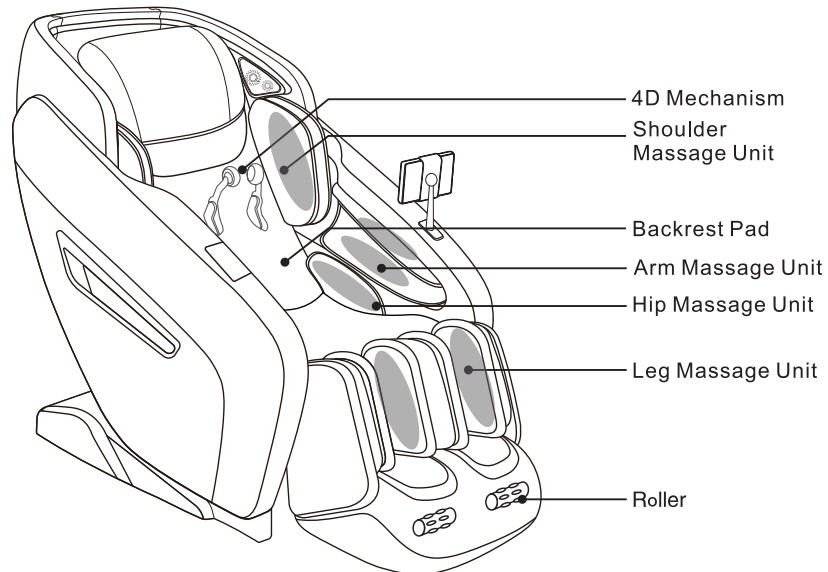
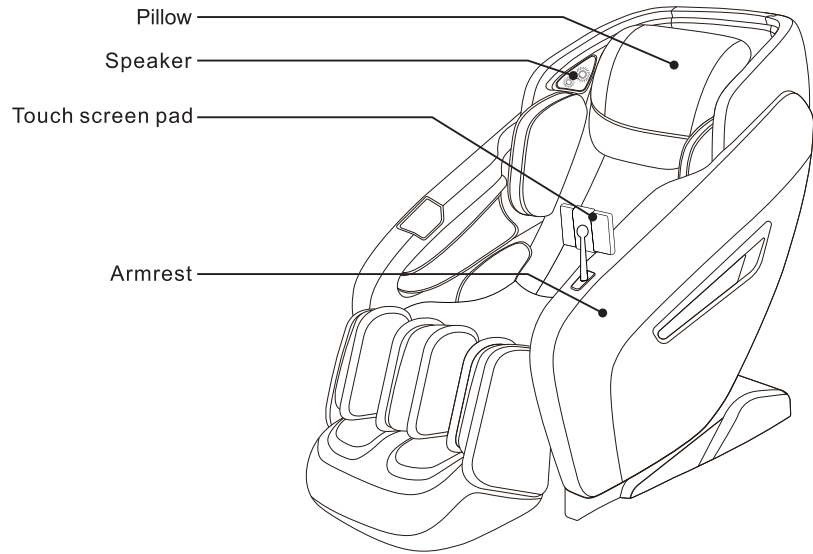

Functions

Functions	Description
3D Mechanism	It can fulfill the forward and backward massage, the width of massage can be adjusted, and massage techniques can be realized by intelligent chip, ultimate massage experience like massage master.
Double SL shape track	Extremely fits the curve of the back of the human body to achieve deep massage of the spine, achieving a long covering from the head and neck massage to the thigh.
7-inch touch screen pad	7-inch large LED touch screen pad for easy operation, one-click collection for customized program.
Full body massage system	Full body flexible airbag, covering from the shoulder to the foot, full body massage.
Automatically adjustable legrest	Automatically adjustable legrest, meet the different heights of whole family, and enjoy the masage in the most comfortable state.
Foot Reflexology	Three rows of rollers are set on the sole of the foot, and circulatorily Guasha your foot, scatter the congested blood, make your foot healthy.
Heating SPA massage, make you feel refreshing.	Simulate hot stone SPA energy therapy, heat treatment on the back, and ventilate blood to activate cells.
Scorpio surrounded 3D sound	Multiple sets of high-fidelity sound chambers, lossless sound quality, like ear-side private concerts, upgraded massage enjoyment.
Energy recovery capsule	The chair can be assisted by zero gravity angle and various swing angles.

Touch Screen Instructions

Intelligent Body Scanning

- When turning the chair on, it will start auto body scan measuring for the key areas of the back including your height. Please relax and lay your head down on the pillow.
- If you are not satisfied with the shoulder&neck detection, please press UP and DOWN to adjust manually, and press OK to confirm.

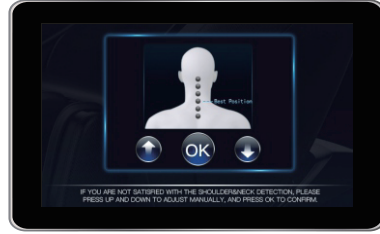
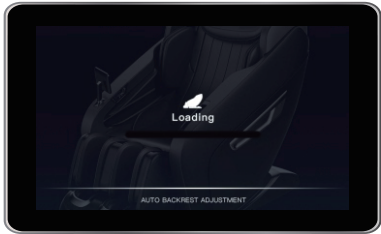

Functions

- You can choose the function according to your needs.
- You can check the Help (?) to know how to use.

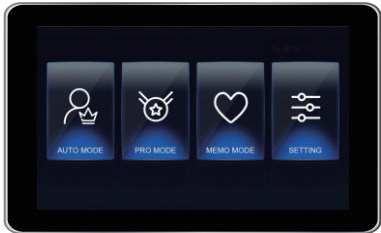

Function	Description
Auto Mode	Choose a professional auto massage programs, which is subject to the actual product.
Pro Mode	According to your own needs, you can choose a suitable massage technique for targeted massage, which can be generated as a proprietary program.
Memo Mode	Choose a favorite program for massage.
Setting	Go to the settings page and set the time, language, brightness, and sound.











Touch Screen Instructions

Auto Mode

	Function	Description	Intensity
Crowd Customized Program	Master	Quickly kneading and tapping massage to relax the tense muscles of the whole body and promote blood circulation to restore the meridians.	High
	Queen	By kneading and shiatsu massage on the buttocks and thighs, the intensity is gentle and moderate, helping to restore physical strength and relax tense muscles.	Medium
	Sport Care	Specially designed for athletes and fitness persons.	Medium
	Soft	Suitable for the elderly and children, roller and airbag massage in the lightest way to improve back pain and leg cramp for the elderly.	Low
Classic Auto Program	DeepShiatsu	According to the shape of the human body, the 3D mechanism massages forwards and backwards from the top to the buttocks, along with the whole body airbags and the foot massage.	High
	Office	Full body massage, medium intensity for airbags, focus on shoulder and neck massage, improve long-term sedentary neck and shoulder pain for office workers.	Medium
	Stretch	Simulating Thai stretch, clamp the shoulders, arms and legs through the airbags. The 3D mechanism lifts up the waist, the legs is pressed down, and the muscles and joints of the whole body are stretched.	High
	Sleep	The massage chair adjusts the position from the zero gravity to normal angel to achieve the swing feature, soft massage and helps fall asleep.	Low
	Spa	Full body airbag massage and foot roller, the 3D mechanism stays in a comfortable position.	Medium
Targeted Area Program	Neck& Shoulder	Focused on the shoulder and neck, medium intensity, and massage techniques are mainly kneading and tapping, which can relax muscles and relieve soreness.	Medium
	Waist&Back	Focused on the back massage, medium intensity. By kneading and clapping, relieve back and waist pain.	Medium
	Slim	Focused on waist and hip massage, soft intensity, twisting waist and hip by airbags in the meanwhile.	Low

Touch Screen Instructions

Shortcut Key

Function	Button	Instruction
Power		Press this power button for 2 seconds to turn on/off the chair.
3D Strength Control		There are 5 strength levels in total, adjust it stronger clockwise, adjust it softer anti-clockwise.
Stop		Press this button to pause the massage function. Press again to resume the original massage function.
Auto		Press this button to switch between multiple automatic program functions.
Zero-G		Each time you press it, switch to a zero-gravity mode.
Reset		Press this button to make chair restore to default position
Back Up/Down		Press the Backrest Up/ Down button to adjust the backrest angle.
		
Leg Up/Down		Press the Leg Up/ Down button to adjust the leg angle.
		

Preparation Before Use

Move the Chair

- Press the chair backrest down to let the caster touch the ground, and then move the chair forward to the location you want to place.

⚠ Attention

- Please hold the chair backrest and bottom to move (recommended for at least 2 people).

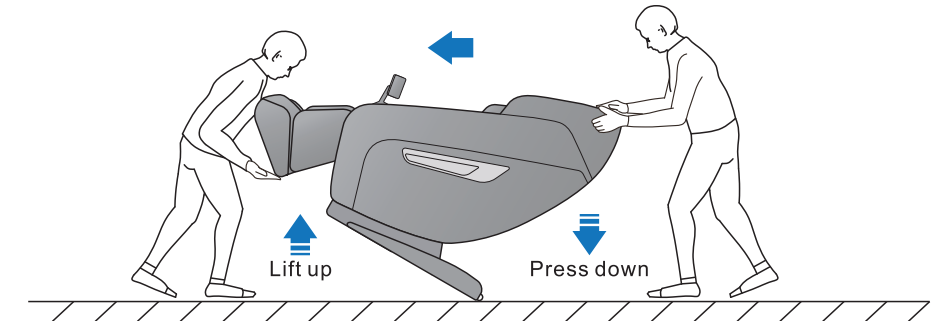

Site of Placement

Please make sure that there is an allowance of more than 5cm behind the massage chair, and more than 35cm in front of the massage chair to allow the backrest to recline without obstruction during operation.

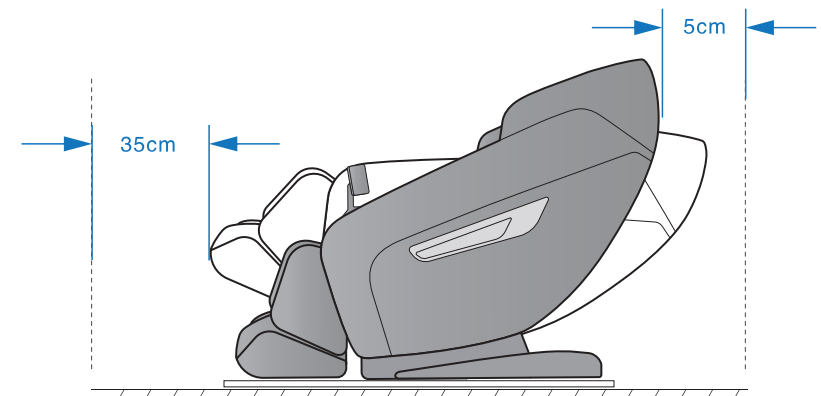

Preparation Before Use

Install the Armrest

- Loosen the screws of plastic back cover, take it off.

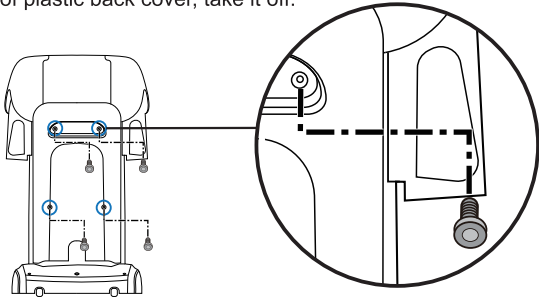

- Install the components as figure 1-5 in order.
- The installation method of the two side armrest is the same.

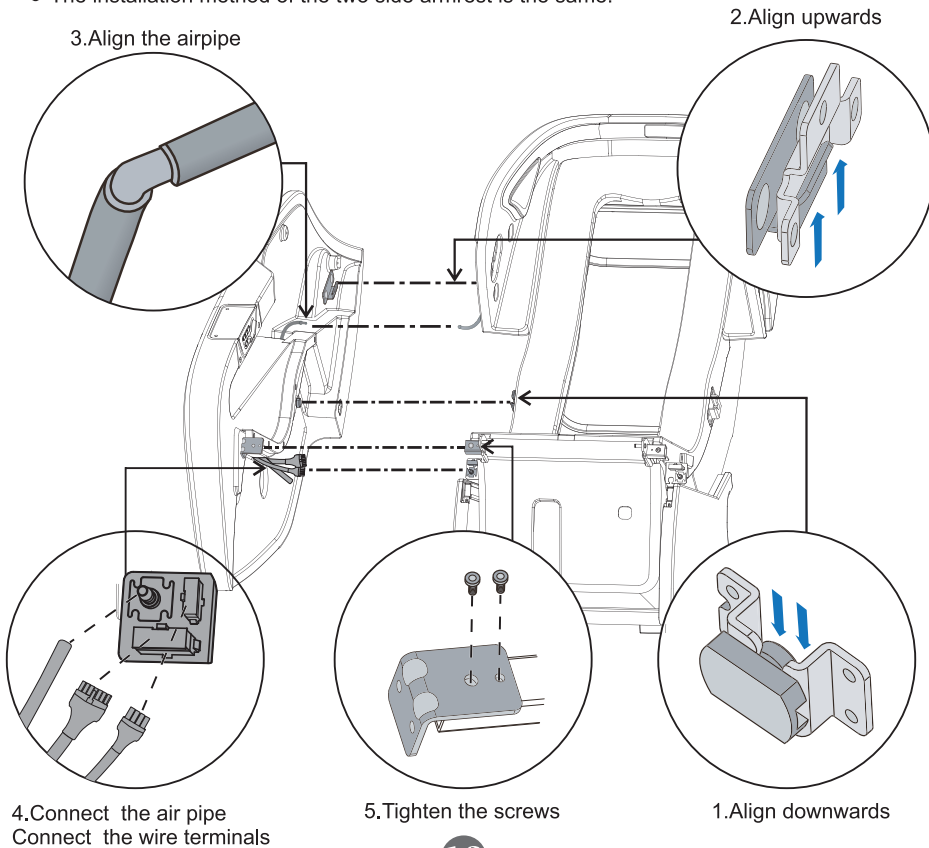

Preparation Before Use

Install the Shoulder Part

- Open the zipper of the shoulder part, then tighten the screws.

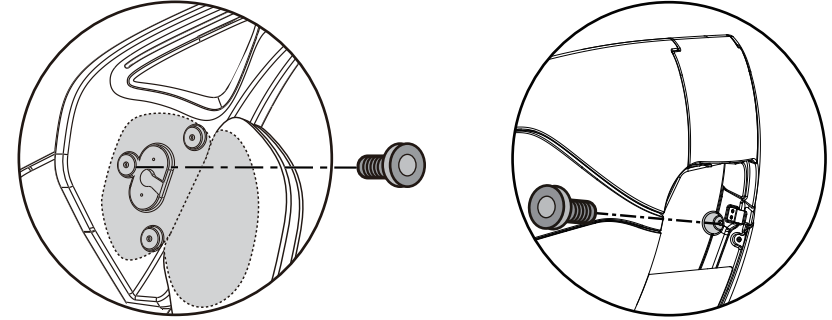

Install the Legrest Part

- Attach the push rod of the legrest to the frame, then insert the pin to make it locked.

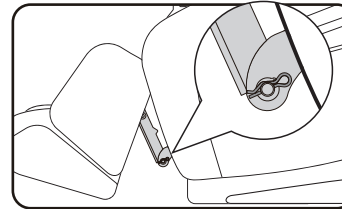

- Insert the air pipes ① of the legrest into the counterpart ② of the chair.

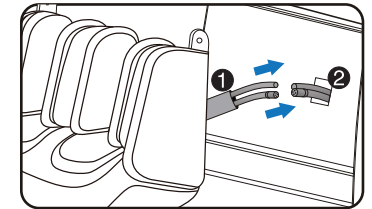

- Put the legrest bracket ③ into the fixed axis ④.

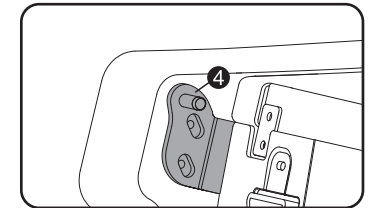
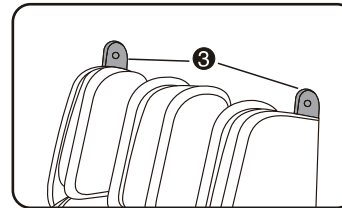

- Insert the clip ⑤, installation is complete.

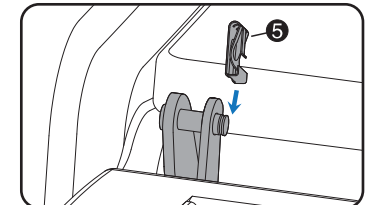
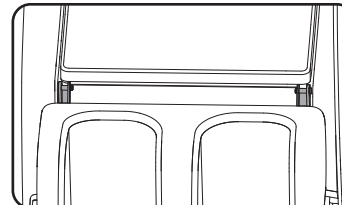

14

Preparation Before Use

Install the Touch Screen Pad

- Install the pad holder onto the handrail of the chair.

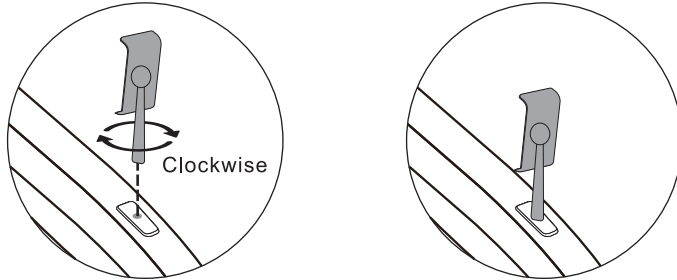

Connect the Air Pipes and Wires for Heating

- Open the backrest pad zipper, turn it up, align the air pipe (the other side is the same method), and connect the wire for heating.
- Connect the cable of touch screen pad to the connecting cable on the bottom of seat.

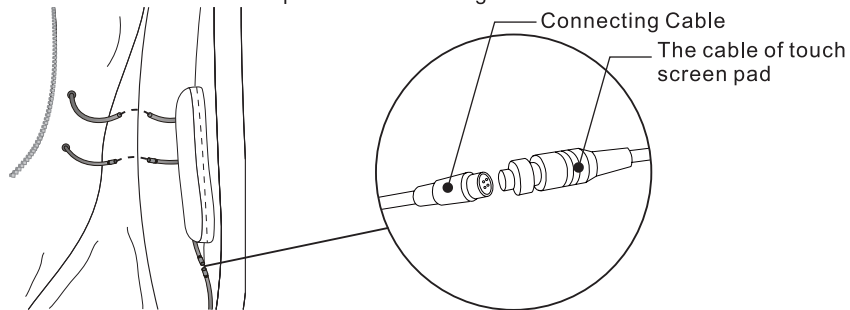

- Install the plastic back cover and tighten the screws.

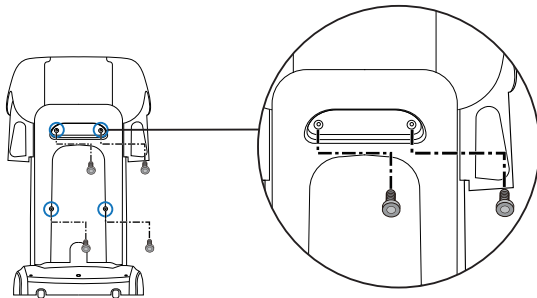

15

Preparation Before Use

Install the Backrest Pad and Pillow

- Connect the backrest pad to the backrest of the chair by zipper.
- Connect the pillow to the backrest pad by velcro. Pillow can decrease the intensity of neck and shoulder massage. Please according to your needs, decide whether to use the pillow. (We suggest you to use the pillow)



Connect Power

- Plug the power cord into power inlet and turn on the power switch.

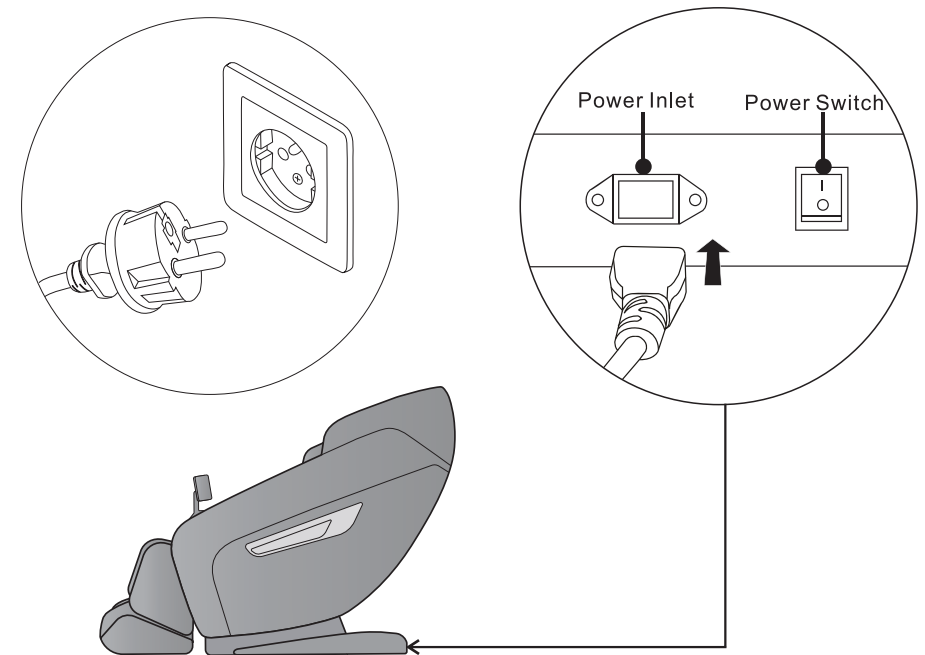

16

Cleaning and Maintenance

Maintenance methods

Please follow the below steps to clean leather and plastic parts

1. Please ensure the main switch is off and the power plug is unplugged from the electrical outlet.
2. Dip a soft, dry cloth in water or warm water containing 3% to 5% neutral detergent and wring it thoroughly.
3. Clean the leather and plastic parts.
4. Then wipe with dry soft cloth.
5. Let it dry naturally.

Warning

- Do not use alcohol, thinner, gasoline and other chemicals for cleaning.
- Do not dry the surface with a blower.
- Do not iron the fabric.
- During maintenance, always unplug the power plug. Do not unplug it by wet hands.
- Please use a dust cover to avoid dust if you won't use the chair for a long time.
- As fabric's color may be dyed on the leather, be careful when using denim and colored cloth to wipe the product.
- Wipe the product with the melamine foam dipped in mild detergent, if the dirt is hard to remove.
- Do not let the leather touch plastic in case of the color fading.
- Water temperature should not exceed 40 Celsius degrees

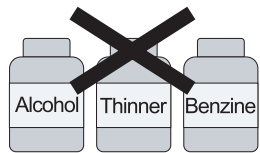

Please do not use



Water Temperature < 40°C

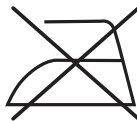

Do not iron

Troubleshoot

If there is still an abnormality after the following checks, to prevent any accident, please stop using the massage chair immediately. Please unplug the power cord from the outlet and contact with the dealer or the nearby customer service center.

Problem	Possible cause/action	
The massage rollers move up and then stop.	<ul style="list-style-type: none"> • In order not to affect the body, the automatic timer function will move the massage roller to the upper end when the massage is over . 	Inevitable in structure, not abnormal
Noise during the massage	<ul style="list-style-type: none"> • The sound of clapping; • Friction sound of the massage wheel and fabric during kneading; • The sound of the massage wheel when lifting and kneading; • The sound during air pressure massage; • The sound of the inflator pump; • The sound of airbag exhausting; • The sound of the backrest up and down. 	
The massage rollers will stop during the massage.	<ul style="list-style-type: none"> • If the force applied to the massage rollers is too large, the massage rollers will stop running. • Lift your body slightly when using it, or raise the backrest slightly. (especially those who weigh more than 100kg, please pay attention when using) 	After checking, if there is still an abnormality, please stop using the massage chair immediately.
Press the power button, but the massage chair doesn't work properly or cannot connect to the power.	<ul style="list-style-type: none"> • Please check the following: <ol style="list-style-type: none"> 1. Is the power plug fully inserted into the socket? 2. Is the main power switch on the left rear of the unit turned on? 	
The power cord and plug are abnormally hot.	<ul style="list-style-type: none"> • Please stop using immediately. 	
		Please contact with your dealer or customer service.
		Do not disassemble or repair it yourself or by non-professionals.

Specifications

Model	R8775W
Rated Voltage	100-240V~
Rated Frequency	50-60Hz
Rated Power	200W
Upright Dimension	1618 (L) x 810 (W) x 1210 (H) mm
Extended Dimension	1804 (L) x 810 (W) x 1015 (H) mm

